

## COMMERCIAL PARKING BLOCK

The type most specified by Architects and Engineers for parking areas where traffic is heavy and continuous. Has two anchor pin holes.

	<u>WEIGHT</u>	<u>PALLET QUANTITY</u>
8 FT. LONG .....	385#	15
6 FT. LONG .....	285#	15
4 FT. LONG .....	190#	15

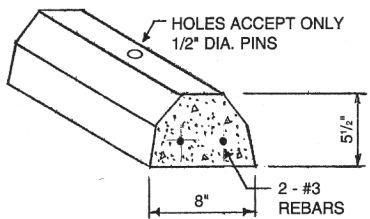

## MEDIUM PARKING BLOCK

This unit combines quality with economy. Designed for residential, apartment, or small business parking areas where space is at a premium. Has two anchor pin holes.

	<u>WEIGHT</u>	<u>PALLET QUANTITY</u>
6 FT. LONG .....	190#	20

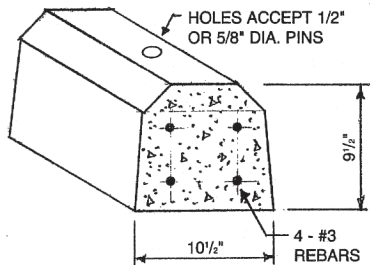

## TEN-HIGH PARKING BLOCK

This unit serves well as a barrier around the perimeter of parking lots, or where extra protection is required. Has three anchor pin holes.

	<u>WEIGHT</u>	<u>PALLET QUANTITY</u>
8 FT. LONG .....	720#	3

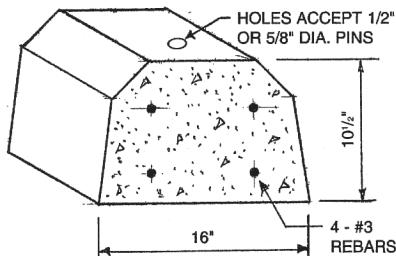

## JUMBO PARKING BLOCK

This unit is specified where stops are required for large Trucks, Tractors, etc., or in parking areas where maximum protection is required around Signs, Planters, Meters, Display Windows, etc. Has three anchor pin holes.

	<u>WEIGHT</u>	<u>PALLET QUANTITY</u>
8 FT. LONG .....	1,180#	2

### AVAILABLE ANCHOR PINS (Not Pointed)

- 1/2" Dia. x 14" long – steel (50 pins per bundle)
- 5/8" Dia. x 24" long – steel (25 pins per bundle)

### BASIC USES AND FEATURES

- As noted for each type shown. Meets requirements of ODOT TE-24 Program.

### COMPOSITION & MATERIALS

- Concrete: Air Entrained, achieving 5000 PSI compressive strength in 28 days.
- Reinforcing: Steel rebars as noted.

### AVAILABLE FINISH

- Smooth As-cast surfaces, natural concrete color.